

 **Sealed Air**

Conflex[®]

Shrink Packaging Machinery

CW-Modular Series

Horizontal Wrapper

Efficient, Reliable, Flexible. Capable of Processing Up to 200 Packages Per Minute!



CW-160 modular shown

Conflex®. Flexible People make Flexible Systems.

Engineered for maximum flexibility, reliability and performance. Conflex shrink packaging equipment incorporates leading-edge technology into designs that can take on the toughest shrink packaging challenges.

Engineered for Maximum Performance

When speed is what you need, look no further than the high-speed, low-maintenance Conflex CW-Modular Series Horizontal Form Fill and Seal Wrapper! Based on a simple yet brilliant mechanical design, the CW-Modular Series features continuous motion and a rotary hot knife sealing system for maximum speed, hand-wheel adjustable controls and electronic eye sensors for exceptional efficiency... yet this system requires no air. Multiple options available to meet many packaging needs.

Conflex CW-Modular Series Features and Benefits

- **Modular system**—Allows for an unprecedented number of infeed system pairings
- **Rotary Cross seal options**—Single or dual rotary head seals
- **Choice of forming plows**—Available in fixed or adjustable height forming plows to meet your exact needs
- **1 HP DC motor**—"One motor" provides the power you need for consistent, dependable operation
- **Cradle style powered feed**—Easy to load with fast change overs
- **Triple safety system**—Protects operators and promotes a safe work environment
- **Multiple options**—Include thermal bottom seal, 5' or 10' infeed extensions, 440V operation, card-style side guides, and more

Conflex CW-Modular Series Plan View*

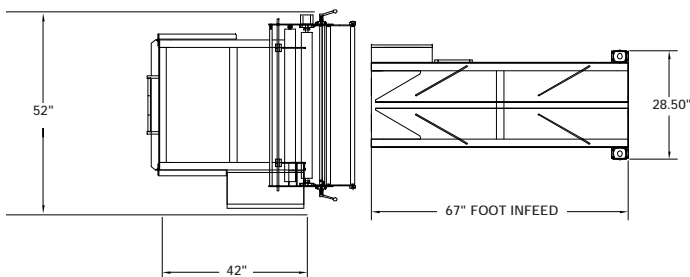

* Shown with 5' infeed.

Conflex CW-Modular Series Specifications

Electrical Requirements	220V, 20A or 440V
Air Requirements	None
Film Requirements	One roll, 3" core, single wound
Seal Bar	16", 20", 24", 28"
Maximum Film Width	34", 38", 42", 46"
Maximum Roll Diameter	13"
Overall Machine Dimensions	109"L x 52"W x 62"H (includes infeed)
Gross Weight	1,600 lbs. (includes infeed)
Maximum Operating Speeds	100, 200 ppm
Deck Height	35.75"-37.75"
Package Dimensions*	3"L to 36"L 2"W to 15"W 1/8"H to 5"H

*May require additional components and set-up time to run the entire size range.

CW-Modular Series Models Available

- CW-200 Horizontal Form Fill and Seal Wrapper—20" seal bar
- CW-240 Horizontal Form Fill and Seal Wrapper—24" seal bar
- CW-280 Horizontal Form Fill and Seal Wrapper—28" seal bar
- CW-160SS Horizontal Form Fill and Seal Wrapper—USDA-approved stainless steel version
- CW-160 Plus Horizontal Form Fill and Seal Wrapper—Features higher speed for faster package processing, 16" seal bar, speeds up to 200 ppm
- CW-160SI Horizontal Form Fill and Seal Wrapper—Features servo infeed for maximum speed, 16" seal bar, speeds up to 200 ppm

The Conflex engineering department is available to customize options for various product applications.

Distributed by:



Conflex Incorporated
Manufacturing Facility:
W130 N 10751 Washington Drive
Germantown, WI 53022
Toll Free: 800-225-4296
Fax: 262-255-4664
E-mail: info@conflex.com
www.conflex.com

© Reg. U.S. Pat. Off. © Sealed Air Corporation 10/2006. Conflex and the Conflex logo are registered trademarks of Conflex Incorporated. All Rights Reserved.